

Amigurumi Toy  
**«FROG SQUISHMALLOW»**

**3 SIZES**

CROCHET PATTERN – Crochet toy



(c) 2021 Tkachenko Olga @amigurushka

**Notice!**

© COPYRIGHT

All AmigurushkaRU patterns are protected by international copyright laws and are intended for personal use only. All rights reserved. It is prohibited to distribute instructions on paper or electronically (you may not sell or share the patterns, do not post them on the Internet, or translate them into other languages). You may sell any item made personally by you according to this pattern. If you have any questions about this pattern, please feel free to contact me!

Thanks and enjoy!

*You can always write me by e-mail [giftelit@yandex.ru](mailto:giftelit@yandex.ru)*

**According to this pattern, you can crochet 3 toys of different sizes.**

### Required materials:

- **Thick (plush) yarn** in three colors. I used
  - *Himalaya Dolphin Baby u Yarn art Dolce* (100rp/120m)
- и *YarnArt Jeans № 53* black (or any black yarn) - for mouth embroidery !!! You can use any yarn that you like
- the appropriate size crochet needle (I used 5,0)
  - safety eyes d 10, 12, 16 (for different size toys, different eye diameter)
  - the filler (I use hollofiber)
  - the big needle for sewing together toy's parts (you may need threaded)
  - scissors

### ***Type Codes:***

**ch** - chain

**sl st** - connective crochet

**sc** - single crochet

**dec(s)** – Decrease(s) (to crochet two sc together)

**inc** – Increase (to crochet two sc into one stitch)

**st(s)** = stitch(es)

**x** - repeat (for example "x 6" - repeat 6 times)

#### **Notes for following my patterns:**

- ✿ Work in spirals. Do not join, slip stitch or turn unless otherwise stated in the pattern.
- ✿ Use a stitch marker in the beginning of each round. This will help to mark the first stitch of every round.
- ✿ Alternative for stitch marker: You can use different colored yarn for stitch markers too. Just place it into the first stitch of every row/round as you go.
- ✿ Alternative for magic ring: Make chain 2. Work 6sc in first chain.
- ✿ Yarn suggestions: If you cannot find the same yarn, you can buy a different brand of yarn. It must be anti-pilling yarn. Yarn size will depend on your hook size.

## SMALL TOY

### BODY

Thick yarn of the main color, hook 5 mm

❁ **Rnd 1:** 2 Ch, 6 Sc with the 2-nd chain from the hook (6)

❁ **Rnd 2:** 1inc x 6 times = (12)

❁ **Rnd 3:** (1 Sc, Inc) x 6 times = (18)

❁ **Rnd 4:** (2 Sc, Inc) x 6 times = (24)

❁ **Rnd 5-10 (6 Rnds):** Sc in all 24 sts = (24)

❁ **Rnd 11:** (2 Sc, Dec) x 6 times = (18)

❁ **Rnd 22:** (1 Sc, Dec) x 6 times = (12)

Add filler.

❁ **Rnd 13:** Dec x 6 times = (6)

Add more filler. Fasten off and cut the thread.

Tighten the loops with a needle. Hide the end of the thread inside.



### EYES (2 ITEAM)

Thick yarn of the main color, hook 5 mm

❁ **Rnd 1:** 7 single crochet in magic ring (7)

❁ **Rnd 2-3 (2 Rnds):** 1sc in all 7 sts = (7)

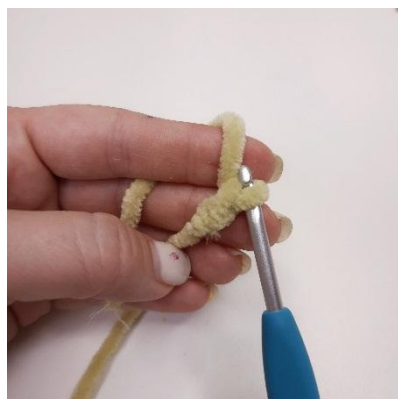

The thread is fasten off and cut. Leave the end of the thread for sewing. Insert 9 mm or 10 mm eyes between the 2-nd and 3-rd rows

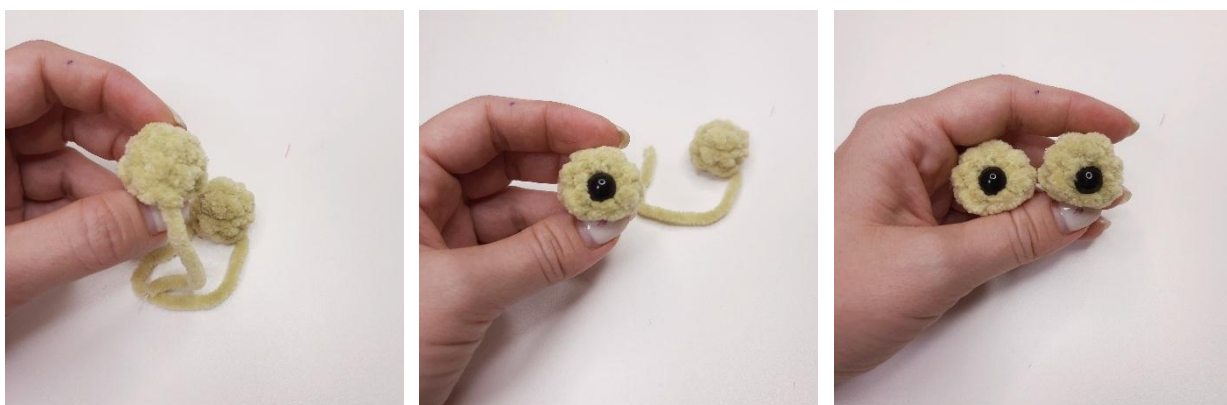

Sew the eyes to the body of the toy as in the photo.



## ARMS (2 ITEM)

Thick yarn of the main color, hook 5 mm

✿ **Rnd 1:** 5 single crochet in magic ring (5)

✿ **Rnd 2:** 1sc in all 5 sts = (5)

Tie both sides of the hand together 2 Sc. Fasten the thread, cut it off, leave the end of the thread for sewing.



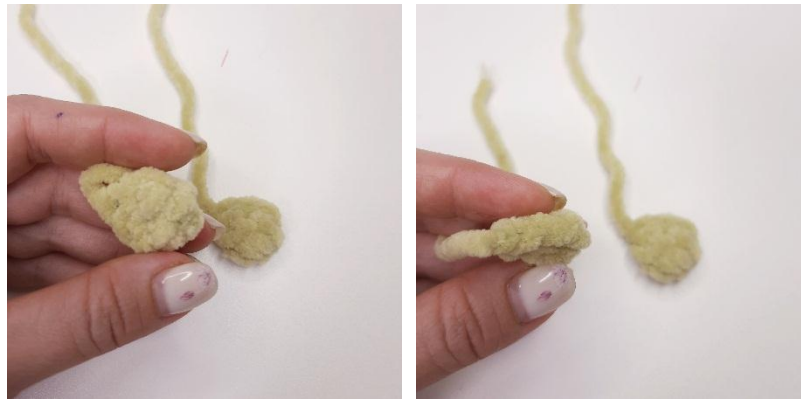

Sew the hands to the body between the 6-th and 7-th rows on the sides (as in the photo)



## TUMMY

Thick white yarn, 5 mm hook

✿ **Rnd 1:** 7 single crochet in magic ring (7)

✿ **Rnd 2:** 1 inc x 7 times = (14)

✿ **Rnd 3:** (1 Sc, inc) x 7 times = (21)

The thread is fasten off, cut. Leave the end of the thread for sewing.

Sew the belly to the body of the toy.



## LEGS (2 ITEAM)

Thick white yarn, 5 mm hook

✿ **Rnd 1:** 5 single crochet in magic ring (5)

✿ **Rnd 2:** 1 inc x 5 times = (10)

✿ **Rnd 3:** 1 sc in all 10 sts (10)

The thread is fasten off, cut. Leave the end of the thread for sewing.

Sew the legs to the body of the toy as in the photo.



Embroider the mouth with a black cotton thread.



Embroider cheeks with pink cotton thread.



## MEDIUM TOY

### BODY

Thick yarn of the main color, hook 5 mm

✿ **Rnd 1:** 2 Ch, 6 Sc with the 2-nd chain from the hook (6)

✿ **Rnd 2:** 1 inc x 6 times = (12)

✿ **Rnd 3:** (1 Sc, Inc) x 6 times = (18)

✿ **Rnd 4:** (2 Sc, Inc) x 6 times = (24)

✿ **Rnd 5:** (3 Sc, Inc) x 6 times = (30)

✿ **Rnd 6:** (4 Sc, Inc) x 6 times = (36)

Add filler. Fasten off and cut the thread.

✿ **Rnd 7-17 (11 Rnds):** 1 sc in all 36 sts = (36)

✿ **Rnd 18:** (4 Sc, Dec) x 6 times = (30)

Add more filler.

✿ **Rnd 19:** (3 Sc, Dec) x 6 times = (24)

✿ **Rnd 20:** (2 Sc, Dec) x 6 times = (18)

✿ **Rnd 21:** (1 Sc, Dec) x 6 times = (12)



Tighten the loops with a needle. Hide the end of the thread inside.

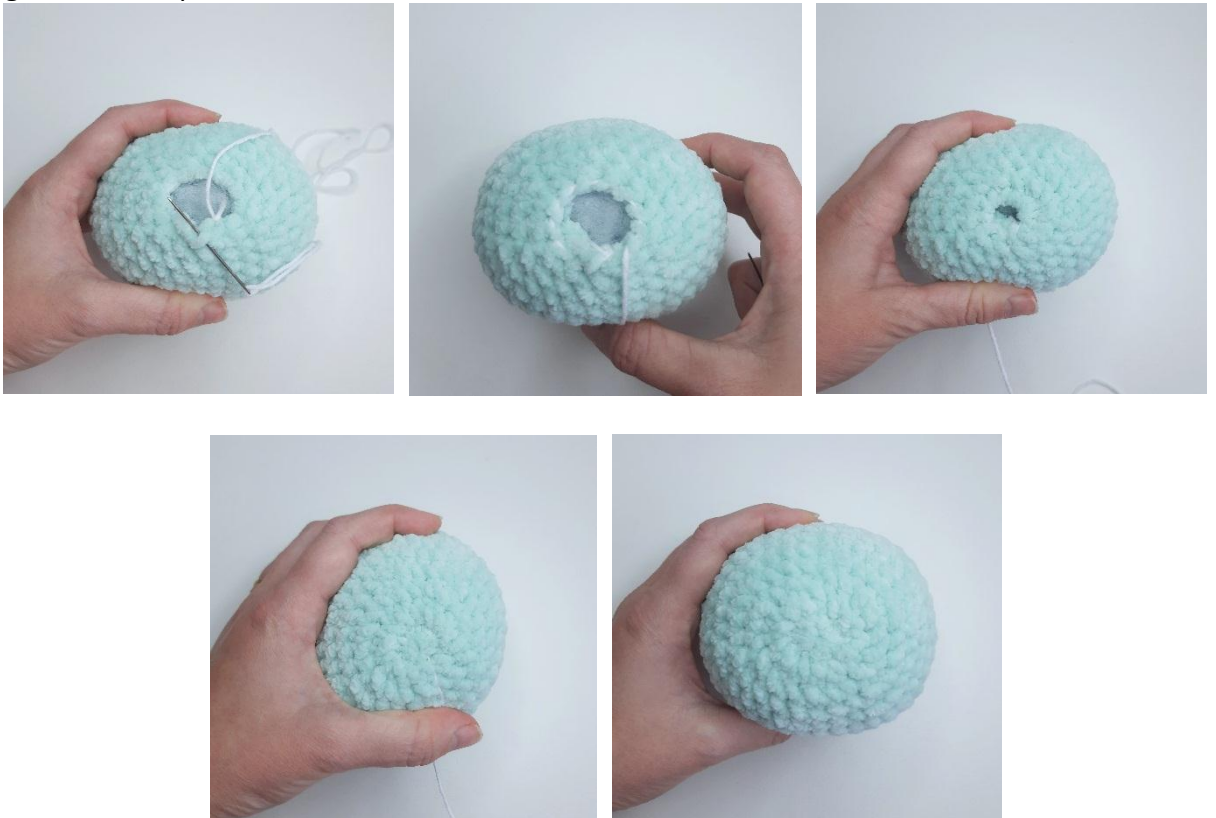

## EYES (2 ITEAM)

Thick yarn of the main color, hook 5 mm

✿ **Rnd 1:** 2 Ch, 6 Sc with the 2-nd chain from the hook (6)

✿ **Rnd 2:** 1 inc x 6 times = (12)

✿ **Rnd 3-4 (2 Rnds):** 1 sc in all 12 sts = (12)

The thread is fasten off and cut. Insert the eyes. The diameter is 12 mm. The location is between the 3-rd and 4-th row from the beginning of crocheting.



Sew the eyes to the toy.



## ARMS (2 ITEAM)

Thick yarn of the main color, hook 5 mm

✿ **Rnd 1:** 6 single crochet in magic ring (6)

✿ **Rnd 2-3 (2 Rnds):** Sc in all 6 sts = (6)

Tie both sides of the hand together 3 Sc. Fasten the thread, cut it off, leave the end of the thread for sewing.

Sew your hands to the toy.





## TUMMY

Thick white yarn, 5 mm hook

- ✿ **Rnd 1:** 7 single crochet in magic ring (7)
- ✿ **Rnd 2:** 1 inc x 7 times = (14)
- ✿ **Rnd 3:** (1 Sc, inc) x 7 times = (21)
- ✿ **Rnd 4:** (2 Sc, inc) x 7 times = (28)

The thread is fasten off, cut. Leave the end of the thread for sewing.

Sew the tummy to the body of the toy.



## LEGS (2 ITEAM)

Thick white yarn, 5 mm hook

- ✿ **Rnd 1:** 6 single crochet in magic ring (6)
- ✿ **Rnd 2:** 1 inc x 6 times = (12)
- ✿ **Rnd 3:** (3 Sc, inc) x 3 times = (15)

The thread is fasten off, cut. Leave the end of the thread for sewing. It can also be sewn with cotton threads.

Sew the legs to the body of the toy as in the photo.





Embroider the mouth with a black cotton thread.



Embroider the cheeks with a plush (or cotton) pink thread.



## BIG TOY

### BODY

Thick yarn of the main color, hook 5 mm

- ✿ **Rnd 1:** 2 Ch, 6 Sc with the 2-nd chain from the hook (6)
- ✿ **Rnd 2:** 1 inc x 6 times = (12)
- ✿ **Rnd 3:** (1 Sc, Inc) x 6 times = (18)
- ✿ **Rnd 4:** (2 Sc, Inc) x 6 times = (24)
- ✿ **Rnd 5:** (3 Sc, Inc) x 6 times = (30)
- ✿ **Rnd 6:** (4 Sc, Inc) x 6 times = (36)
- ✿ **Rnd 7:** (5 Sc, Inc) x 6 times = (42)
- ✿ **Rnd 8:** (6 Sc, Inc) x 6 times = (48)
- ✿ **Rnd 9:** (7 Sc, Inc) x 6 times = (54)
- ✿ **Rnd 10-25 (16 Rnds):** 1 sc in all 36 sts = (54)
- ✿ **Rnd 26:** (7 Sc, Dec) x 6 times = (48)
- ✿ **Rnd 27:** (6 Sc, Dec) x 6 times = (42)
- ✿ **Rnd 28:** (5 Sc, Dec) x 6 times = (36)
- ✿ **Rnd 29:** (4 Sc, Dec) x 6 times = (30)  
Add filler.
- ✿ **Rnd 30:** (3 Sc, Dec) x 6 times = (24)
- ✿ **Rnd 31:** (2 Sc, Dec) x 6 times = (18)
- ✿ **Rnd 35:** (1 Sc, Dec) x 6 times = (12)



Add more filler. Fasten off and cut the thread. Tighten the loops with a needle. Hide the end of the thread inside.



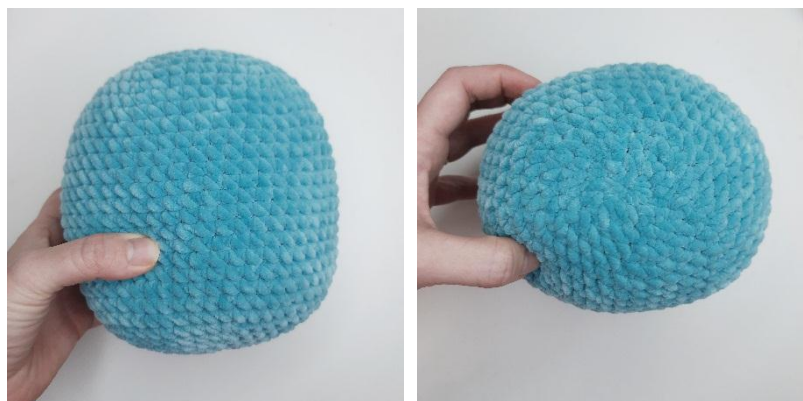

## EYES (2 ITEM)

Thick yarn of the main color, hook 5 mm

✿ **Rnd 1:** 2 Ch, 6 Sc with the 2-nd chain from the hook (6)

✿ **Rnd 2:** 1 inc x 6 times = (12)

✿ **Rnd 3:** (1 Sc, Inc) x 6 times = (18)

✿ **Rnd 4:** (2 Sc, Inc) x 6 times = (24)

✿ **Rnd 5-7 (3 Rnds):** 1 sc in all 24 sts = (24)

The thread is fasten off and cut. Insert the eyes. The diameter is 16 mm. The location is between the 5-th and 6-th row from the beginning of crocheting.



Sew the eyes to the toy.





## ARMS (2 ITEM)

Thick yarn of the main color, hook 5 mm

- ✿ **Rnd 1:** 6 single crochet in magic ring (6)
- ✿ **Rnd 2:** (Inc, 2 Sc) x 2 times = (8)
- ✿ **Rnd 3:** (Inc, 3 Sc) x 2 times = (10)
- ✿ **Rnd 4:** Sc in all 10 sts = (10)

Tie both sides of the hand together 5 Sc. Fasten the thread, cut it off, leave the end of the thread for sewing.

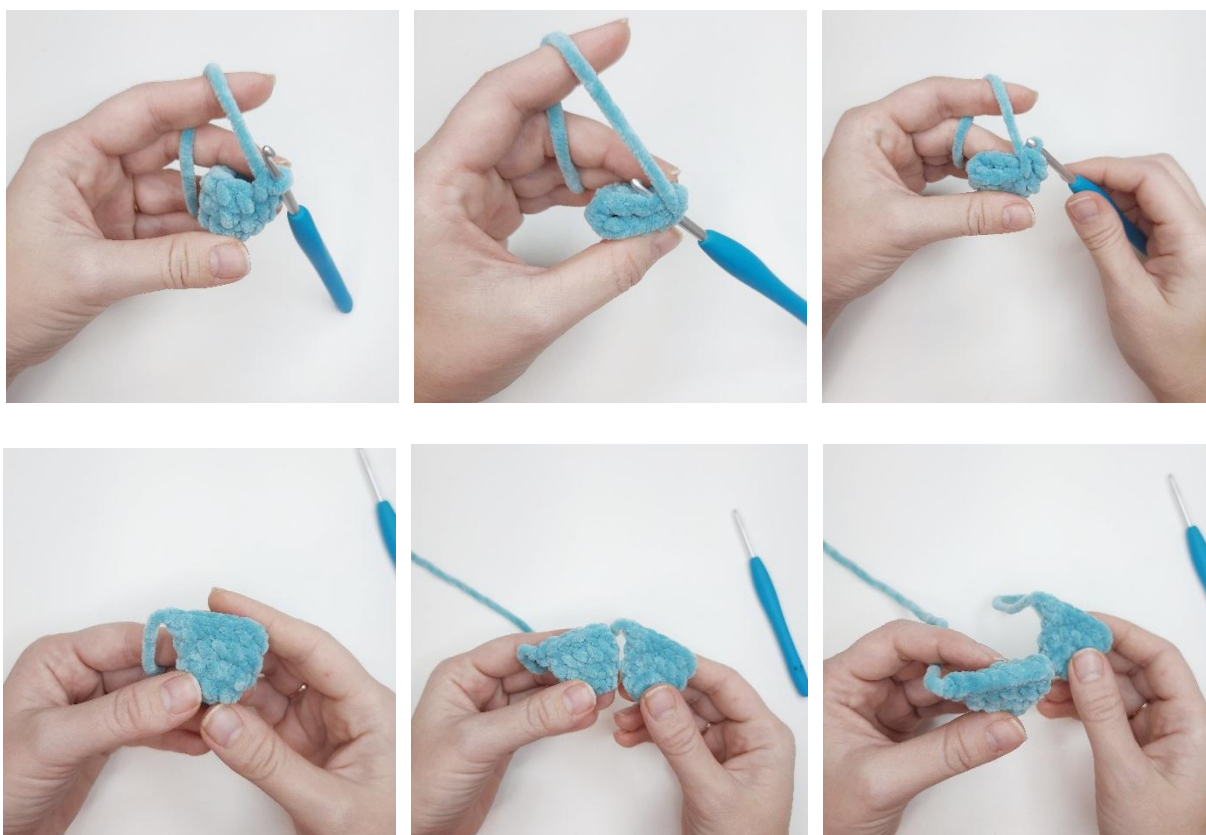

Sew the hands to the body between the 15-th and 16-th rows on the sides (as in the photo)



## TUMMY

Thick white yarn, 5 mm hook

- ✿ **Rnd 1:** 7 single crochet in magic ring (7)
- ✿ **Rnd 2:** 1 inc x 7 times = (14)
- ✿ **Rnd 3:** (1 Sc, inc) x 7 times = (21)
- ✿ **Rnd 4:** (2 Sc, inc) x 7 times = (28)
- ✿ **Rnd 5:** (3 Sc, inc) x 7 times = (35)
- ✿ **Rnd 6:** (4 Sc, inc) x 7 times = (42)
- ✿ **Rnd 7:** (5 Sc, inc) x 7 times = (49)



The thread is fasten off, cut. Leave the end of the thread for sewing.



## LEGS (2 ITEAM)

Thick white yarn, 5 mm hook

- ✿ **Rnd 1:** 2 Ch, 6 Sc with the 2-nd chain from the hook (6)
- ✿ **Rnd 2:** 1 inc x 6 times = (12)
- ✿ **Rnd 3:** (1 Sc, inc) x 6 times = (18)
- ✿ **Rnd 4:** (2 Sc, inc) x 6 times = (24)
- ✿ **Rnd 5:** (7 Sc, inc) x 3 times = (27)
- ✿ **Rnd 6-7 (2 Rnds):** Sc in all 27 sts = (27)

Sew the legs to the bottom of the toy, adding filler.





Embroider the mouth with a black cotton thread.



Embroider the cheeks with a plush (or cotton) pink thread.

