

Attendance 2023

	Jan	Feb	Mar	Apr	May	Jun	Jul	Aug	Sep	Oct	Nov	Dec	Avg
Worship	153	224	180	195	186	159	154	204	214				185

Nursery	8	10	6	9	11	7	7	8	10	14			9
PreK-6 Grade	21	35	25	30	20	20	22	30	38				27
7-12 Grades	21	23	21	24	19	18	15	26	20				21
Brad F. Class	6	9	9	12	2	4	5	7	9				7
Kirt H. Class	25	25	21	24	20	18	19	21	20				21
Rick W. Class	11	12	4	2	11	14	11	13	14				10
Donna A. Class	11	17	26	23	13	14	13	13	16				16
Kent L. Class	8	8	12	12	7	7	6	6	6				8
Frank G. Class	3	2	3	3	1	2	1	2	2				2
Total Sunday School	114	141	125	140	103	104	98	124	136				121

Growth 2017-Present with 20-year Projection

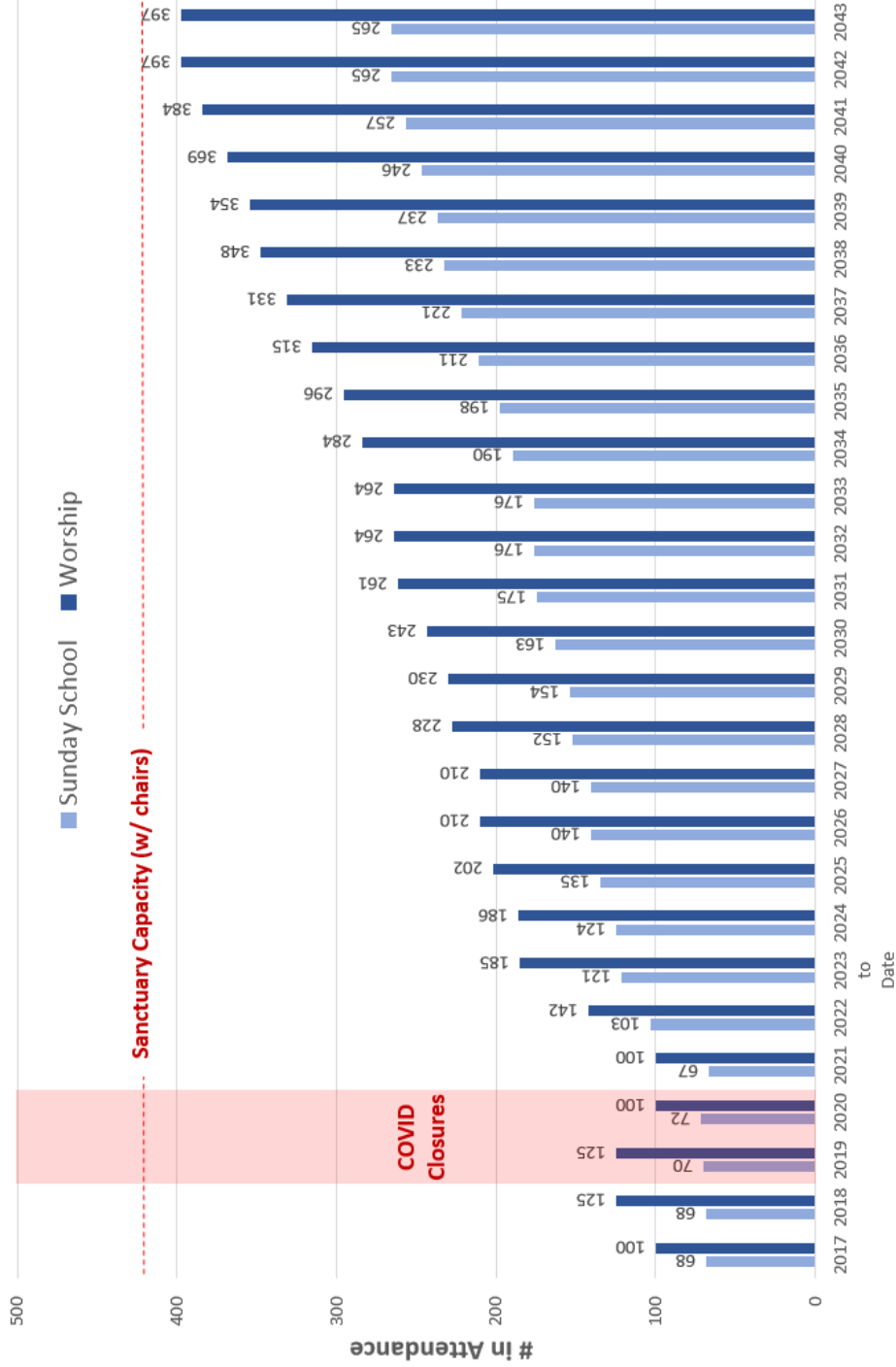

The annual average growth rate for 2017-2022 was 8.4%.
Projected numbers for 2024-2043 are based on an average annual growth rate of 4.2%.

Proposed East Educational Wing

New Construction (11,213 sqft): gathering and check-in area, fourteen classrooms, two offices with workroom, adult restrooms, and dedicated children's restrooms

Capacity: 115 (5 adult rooms) + 76 (4 youth rooms) + 78 (5 children's rooms) = 269

Estimated Cost: \$2,200,000 (includes 20% over-run cost)

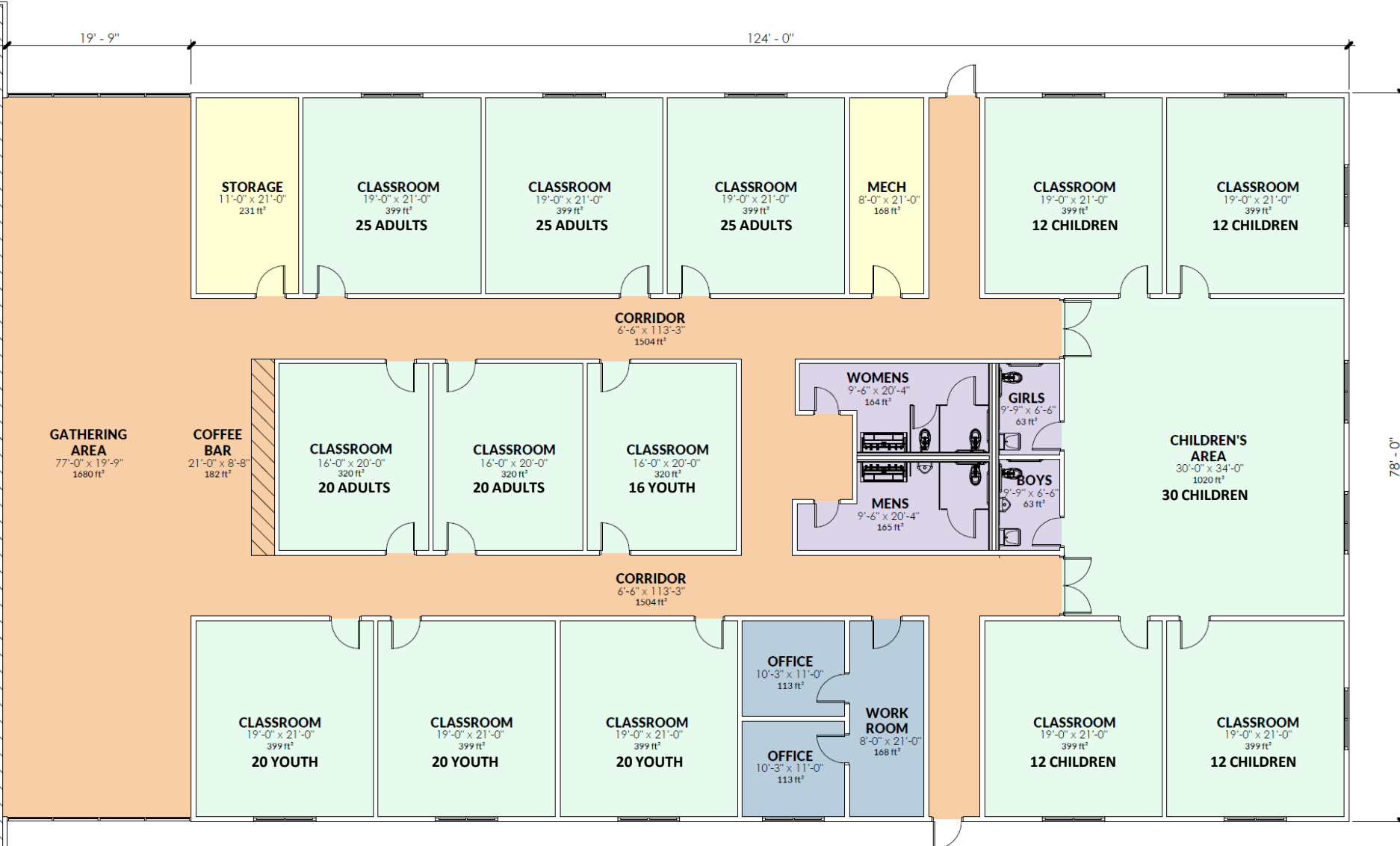

Building Fund: \$292,000 **General Fund:** \$225,000 **Borrowing Capacity:** \$1,400,000 **20-yr Amortization:** \$2,215,000 **Monthly Payment:** \$9,230